

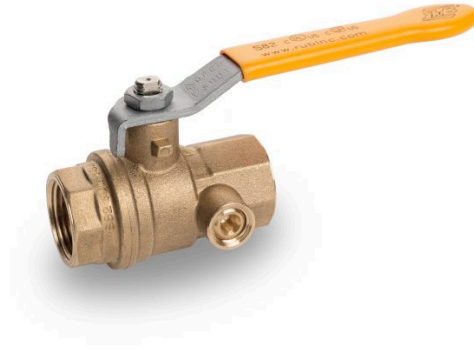

s.82 NPT side drain

full port 1/2" - 2"
hot forged brass ball valve



Quality

- 24h 100% seal test guaranteed
- Dual sealing system allows valve to be operated in either direction making installation easier
- No metal-to-metal moving parts
- No maintenance ever required
- Handle clearly shows ball position
- Silicone-free lubricant on all seals
- Handle stops on body to avoid stress at stem
- Chrome plated brass ball for longer life

Body

- Hot forged sand blasted, unplated brass body and cap sealed with Loctite® or equivalent thread sealant
- Side drain allows easy and safe downstream line venting
- Finest brass according to EN 12165 and EN 12164 (formerly DIN 17660 and UNI 5705-65) specifications

Stem

- Blowout-proof nickel plated brass stem
- Maintenance-free, double FPM O-rings at the stem for maximum safety

Sealing

- Pure PTFE self-lubricating seats with flexible-lip design

Threads

- NPT taper ANSI B.1.20.1 female by female threads
- 1/4" NPT side tap

Flow

- Full port to DIN 3357 for maximum flow

Handle

- Geomet® carbon steel handle with thick PVC dip coating. Handle coating offers both thermal and electrical protection
- **WARNING:** do not exceed reasonable temperature and/or electrical load
- Handle removable with valve in service

Working pressure & temperature

- 600 PSI non-shock cold working pressure
- -40°F/+350°F
- **WARNING:** freezing of the fluid in the installation may severely damage the valve

Options

- Stem extension
- T-handle
- Oval lockable handle
- AISI 430 stainless steel handle
- Patented locking device
- Stubby handle
- **RuB** memory stop designed to be installed with our stubby handle

Upon request

- AISI 316 stainless steel ball and/or stem
- Glass filled PTFE seals
- Custom design
- Dual side drain port

Approved by or in compliance with

- Canadian standards Association (United States, Canada)
- GOST-R (Russia)
- RoHS Compliant (EU)
- Underwriters Laboratories (United States & Canada)

NOTE: approvals apply to specific configurations/sizes only.



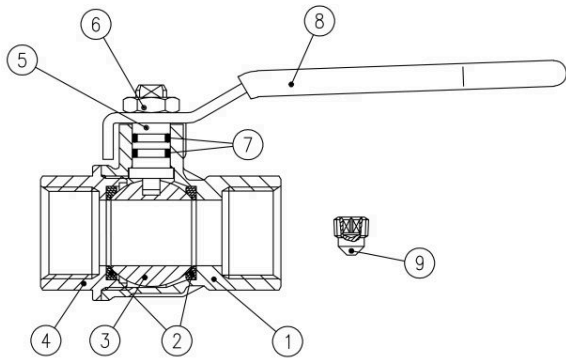

	PART DESCRIPTION	Q.TY	MATERIAL
1	Unplated body	1	CW617N
2	Seat	2	PTFE
3	Chrome plated ball	1	CW617N
4	Unplated end-cap	1	CW617N
5	Nickel plated stem O-ring design	1	CW617N
6	Geomet® nut	1	CB4FF
7	O-Ring	2	FPM
8	Yellow PVC coated Geomet® steel handle	1	DD11
9	Unplated plug	1	CW617N

1.1/4"-2" hollow ball

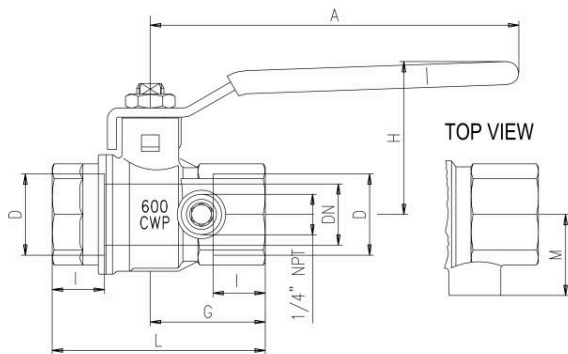

Code	S82D41	S82E41	S82F41	S82G41	S82H41	S82I41
D (inch)	1/2	3/4	1	1 1/4	1 1/2	2
DN (inch)	0.590	0.787	0.984	1.259	1.574	1.968
I (inch)	0.610	0.669	0.826	0.905	0.905	1.043
L (inch)	2.559	2.736	3.405	3.878	4.232	4.960
G (inch)	1.397	1.476	1.811	2.047	2.224	2.578
A (inch)	3.937	4.724	4.724	6.220	6.220	6.220
H (inch)	1.679	1.956	2.114	2.858	3.094	3.370
M (inch)	0.964	1.063	1.200	1.338	1.516	1.752
CH (inch)	0.984	1.220	1.574	1.929	2.125	2.696
Cv (GPM)	32.3	48.5	80.9	92.4	144.4	206.8

DN shows the nominal flow diameter. Actual flow diameter complies with full port DIN 3357 part 4.

Pressure-temperature chart

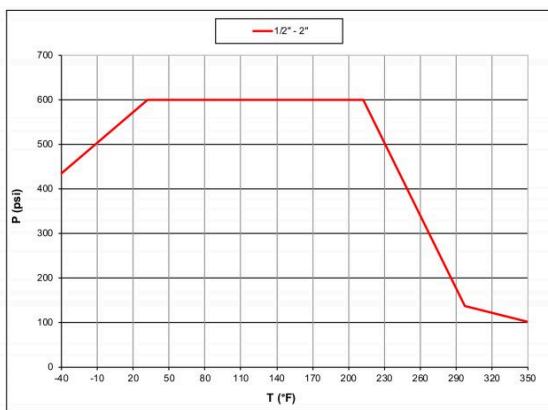

Pressure drop chart

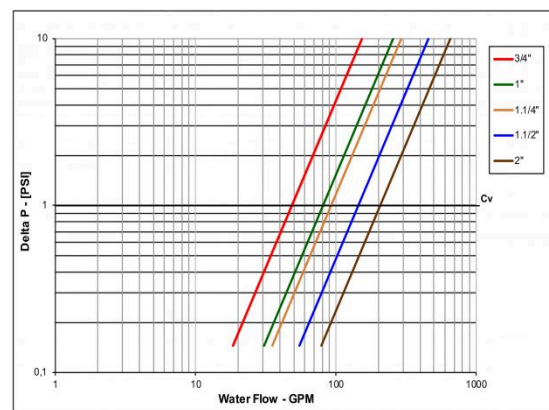

Ask for additional information on the whole range of **RuB** products and consult with your supplier for special applications.
For complete disclaimer: www.rubinc.com/disclaimer